

STUDEBAKER US6 TRUCK

ASSEMBLY AND PAINTING GUIDE



Get your troops to the front with the Studebaker US6!

One of the United States' great strengths in World War II was the ability to produce vast numbers of transport vehicles for their forces, including hundreds of thousands of Studebaker US6s. These rugged, reliable workhorses would be used for almost every task imaginable, and were exported in vast numbers to the Soviet Union under Lend-Lease.

On the Bolt Action tabletop this truck uses the 2.5 Ton Truck profile (page 84, Armies of the United States), providing excellent mobility for your American or Soviet infantry. If you need to move up to 18 US or Soviet soldiers around, look no further! Packed with detail, this multi-part plastic kit is a great opportunity to add both style and transport capacity to your force.

Studebaker US6 Truck

Manufacturer:	Studebaker and REO
Designed:	Before 1940
Produced:	1941-1945
No. built:	More than 200,000
Type:	2½-ton 6x6 trucks and 5-ton 6x4 trucks
Mass:	9,875 lb (4,479 kg) empty
Top speed:	45 mph (72 km/h)
Length:	20 ft 11 in (6.38 m)
Width:	7 ft 4 in (2.24 m)
Height:	7 ft 3 in (2.21 m) top of cab 8 ft 10 in (2.69 m) overall
Engine:	Hercules JXD inline-6 gasoline motor 86 hp (64 kW)
Transmission:	5 speed × 2 range transfer case
Suspension:	Beam axles on leaf springs
Range:	236 mi (380 km)

ASSEMBLY GUIDE KEY



Assembly stage



Do not glue

22

Part number



Previous assembly stage



Optional assembly

Follow this simple guide to build your Studebaker US6 Truck.

Carefully remove each component from the frame with clippers or a craft knife. Trim off excess plastic before assembling. Test fit all parts before applying glue.

We recommend using polystyrene cement to assemble the kit, and to use this in a well-ventilated area.

Keep tools, glues, paints and small components away from children. Warlord Games recommends this kit for ages 14 and over.

DECAL APPLICATION GUIDE

- Apply a coat of gloss varnish to the areas that will receive the decal and allow this to dry fully.
- Cut out a decal from the sheet and soak it in lukewarm water for 1-2 minutes.
- Once the design has started to separate from the backing paper, use tweezers or a wet paintbrush to slide the design into place on the model.
- Use a tissue to dab away any excess water from the model and allow to dry.
- Apply a coat of matt varnish to seal the decal in place.



- A** - US Army marking
- B** - Nickname
- C** - US serial numbers
- D** - US stars
- E** - US flags
- F** - US star



- G** - Soviet slogans
- H** - Soviet stars
- I** - Soviet stars
- J** - Soviet stars
- K** - Soviet numbers
- L** - Soviet squad markings

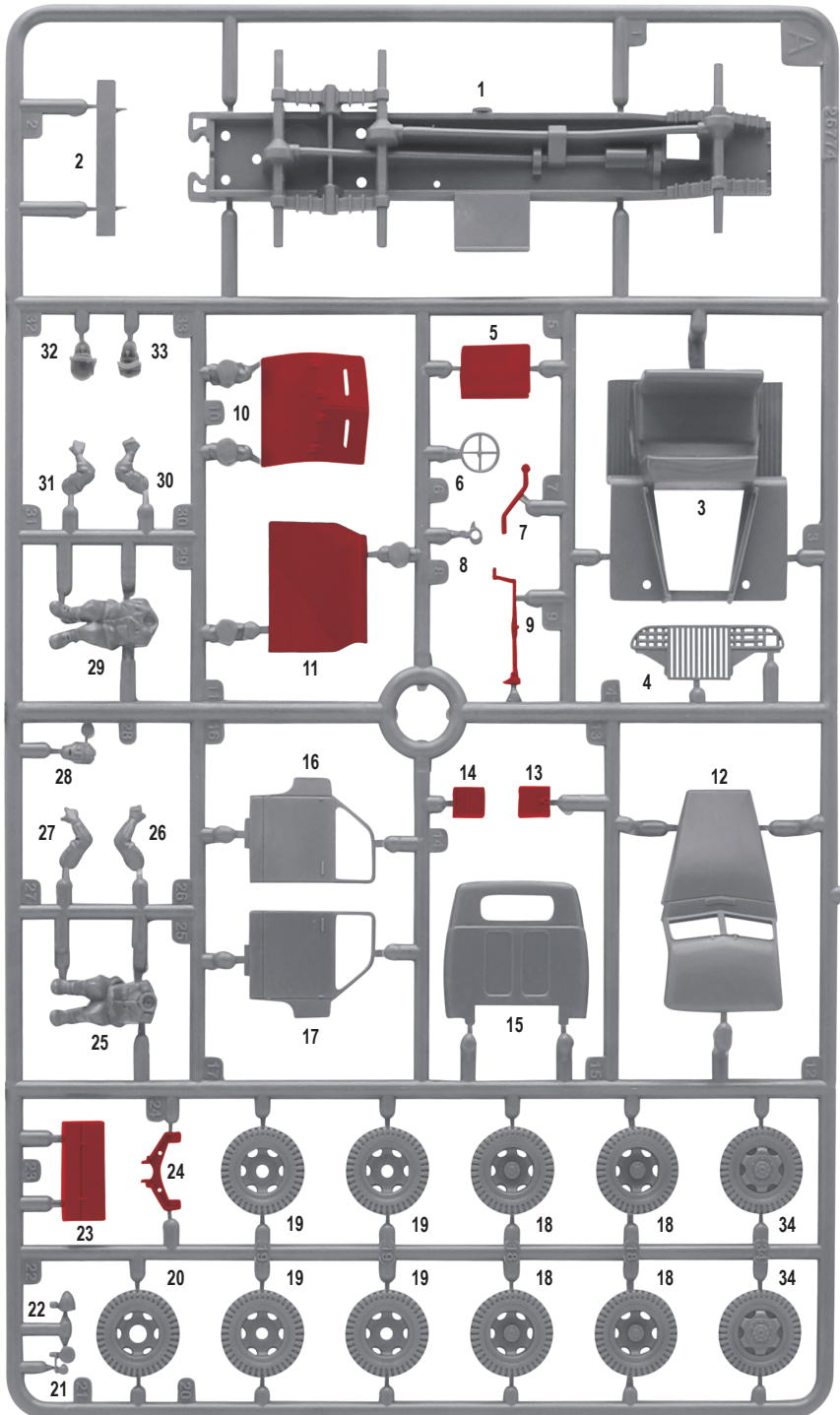

Do not use parts highlighted in red

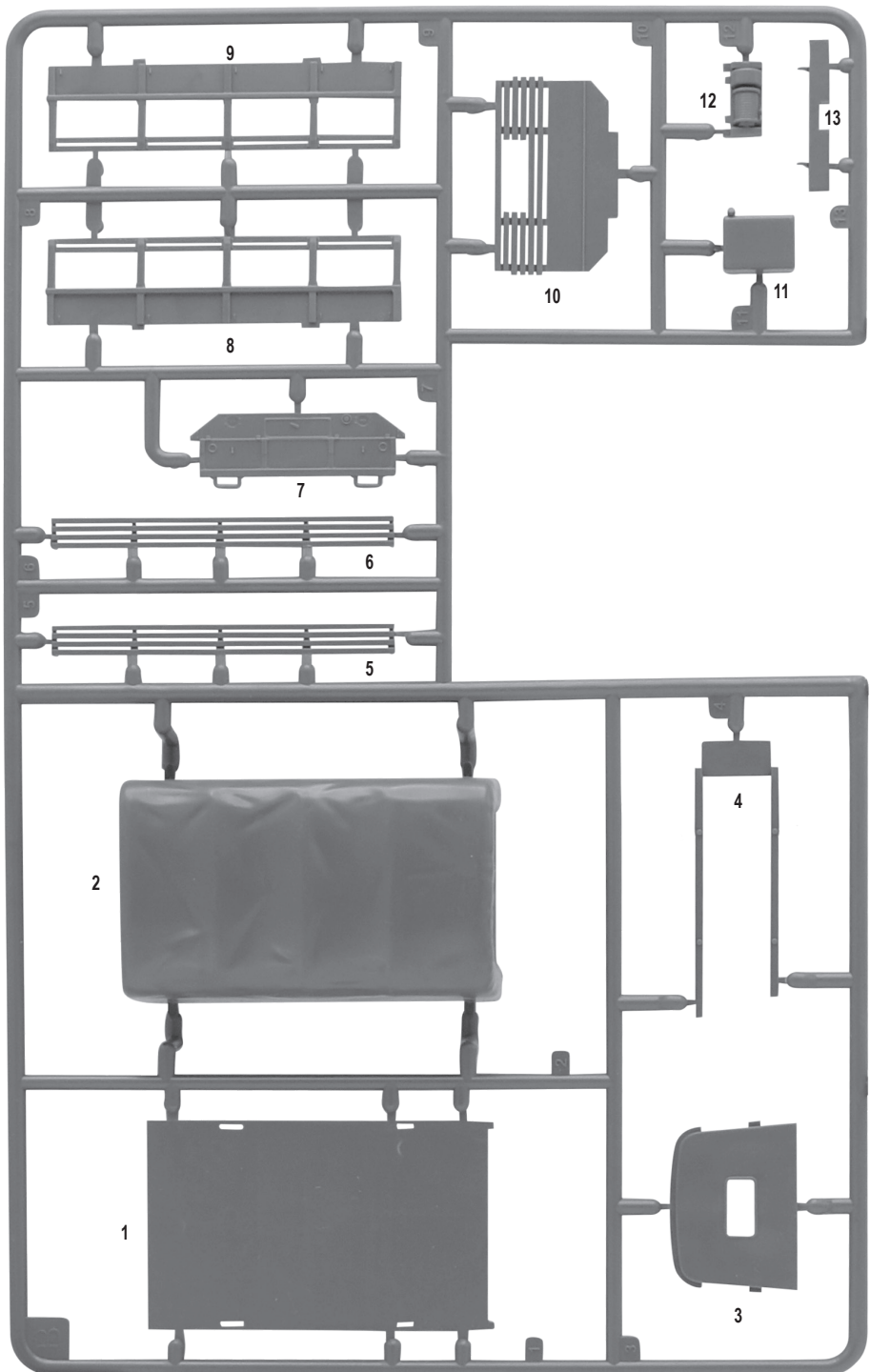

Both variants

A

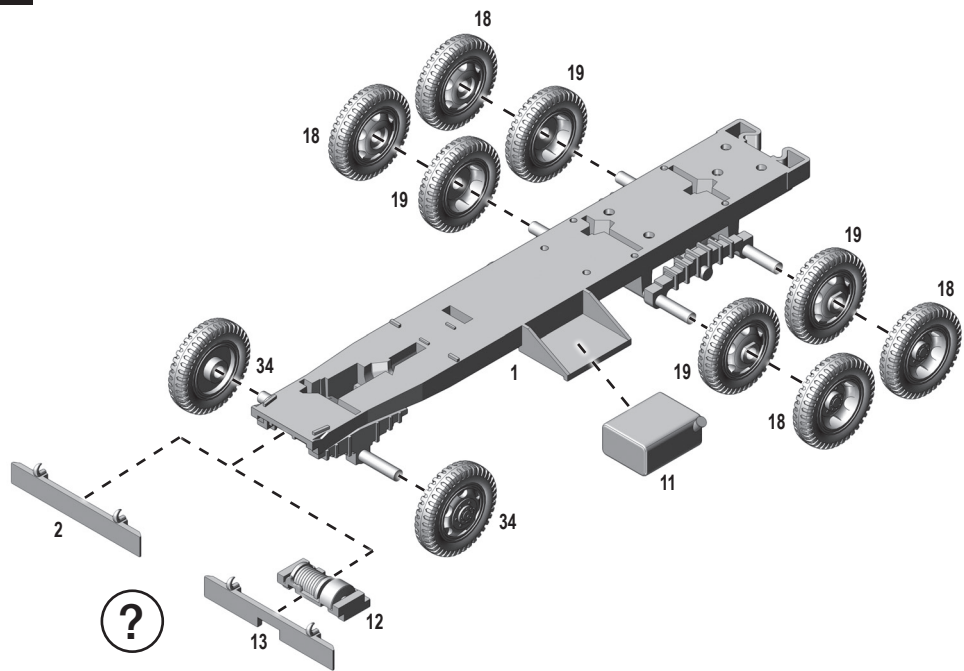

Option with winch or bare fender

B

Soviet driver

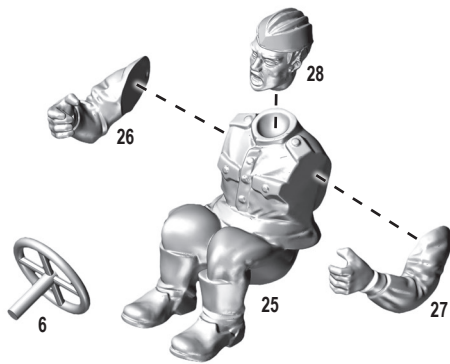

Driver option



US driver

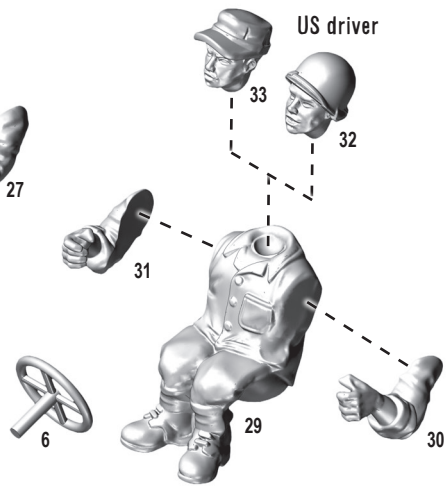

C

Driver option



B



Soviet driver



US driver

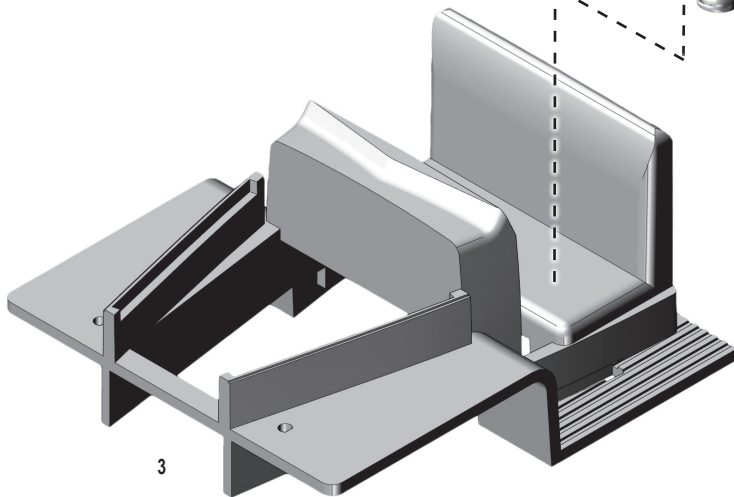

3





D

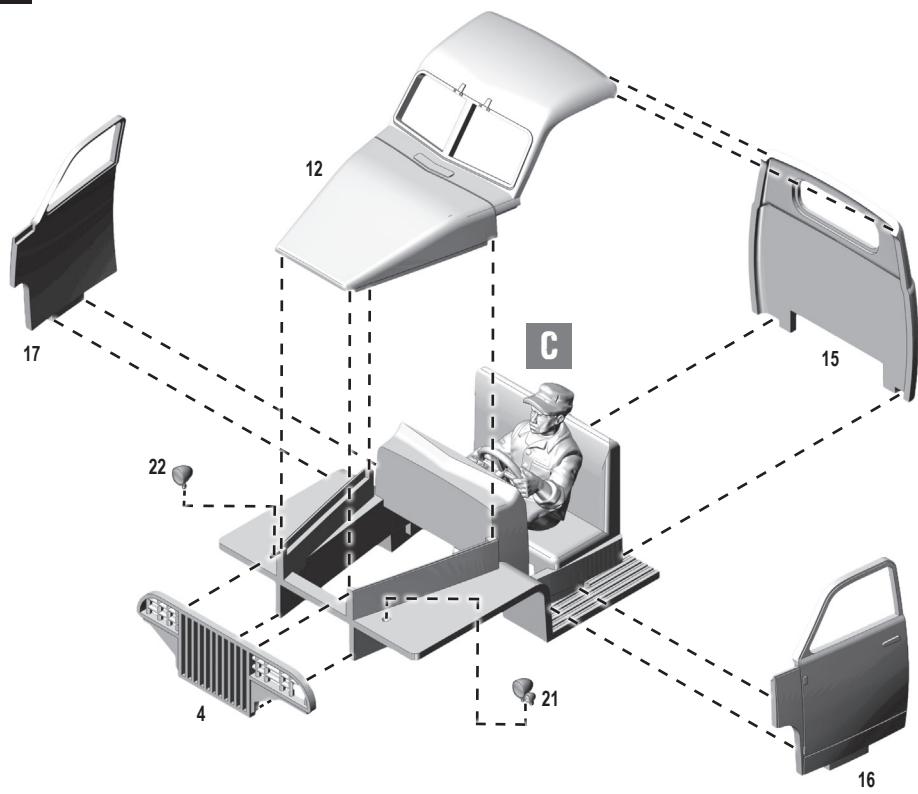

E

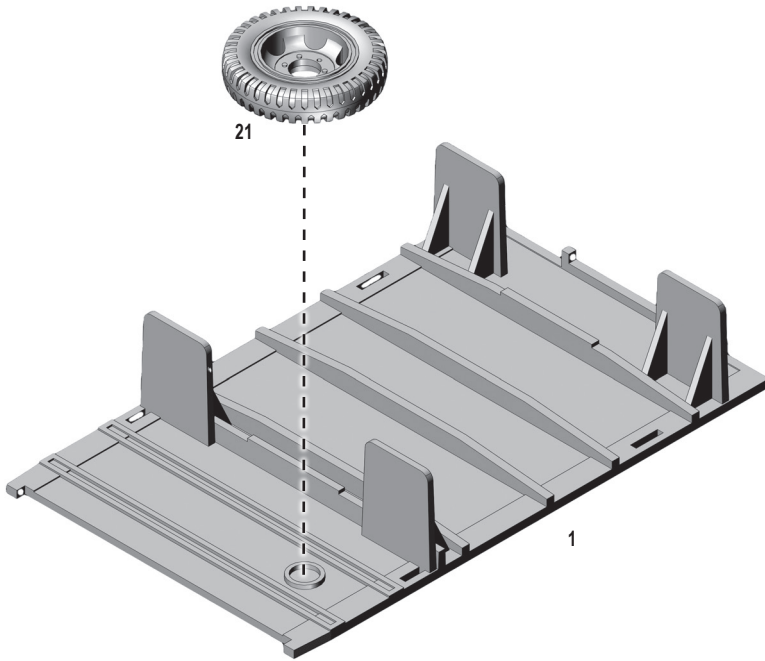

F

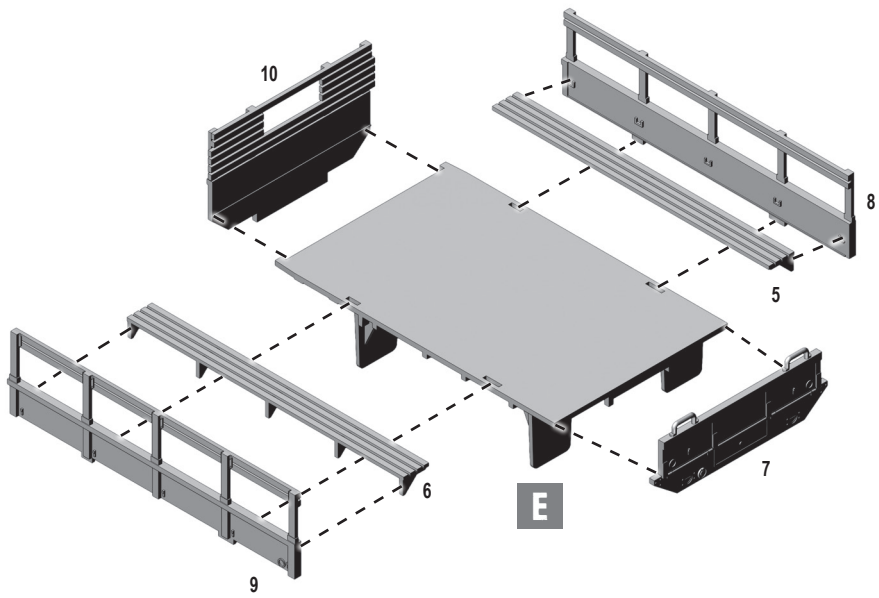

G

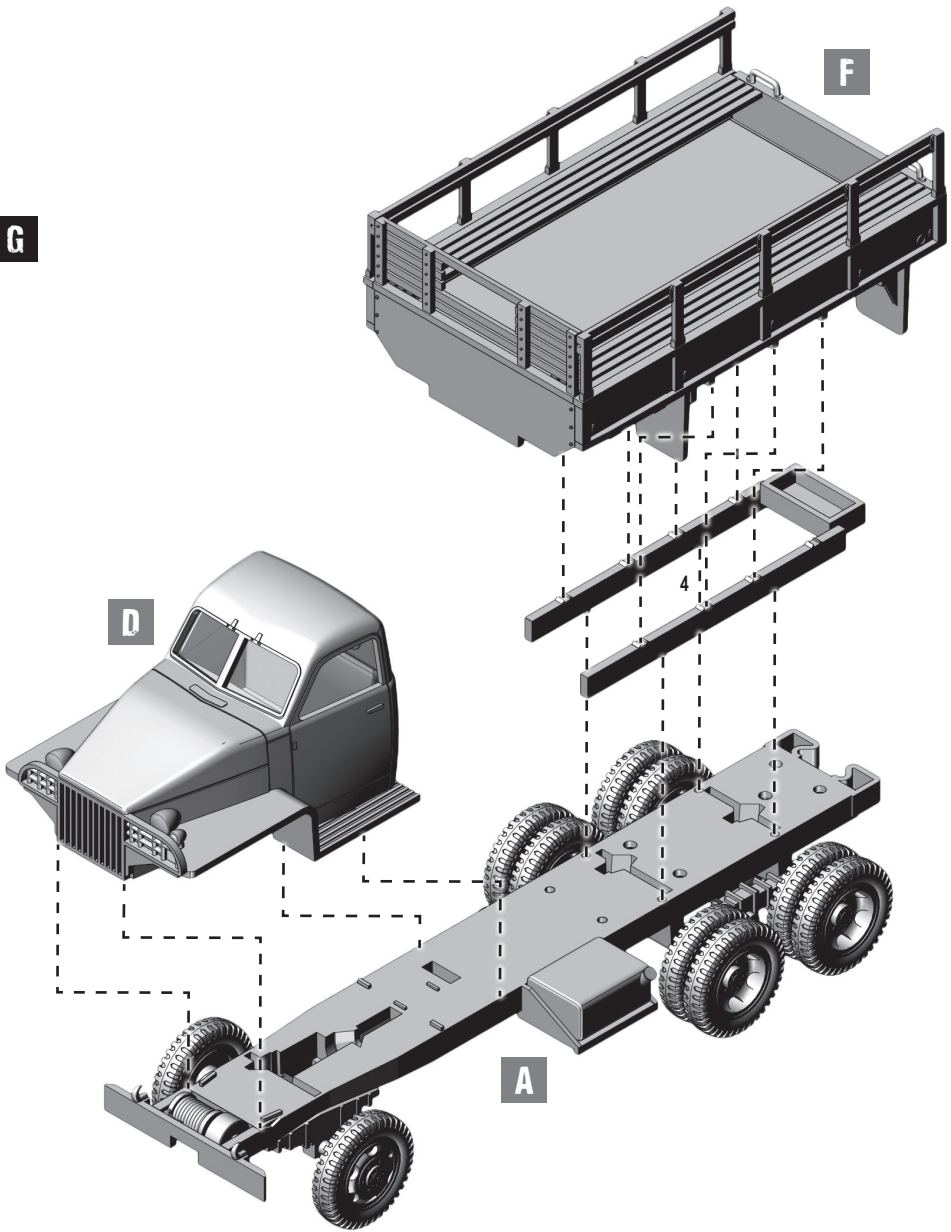

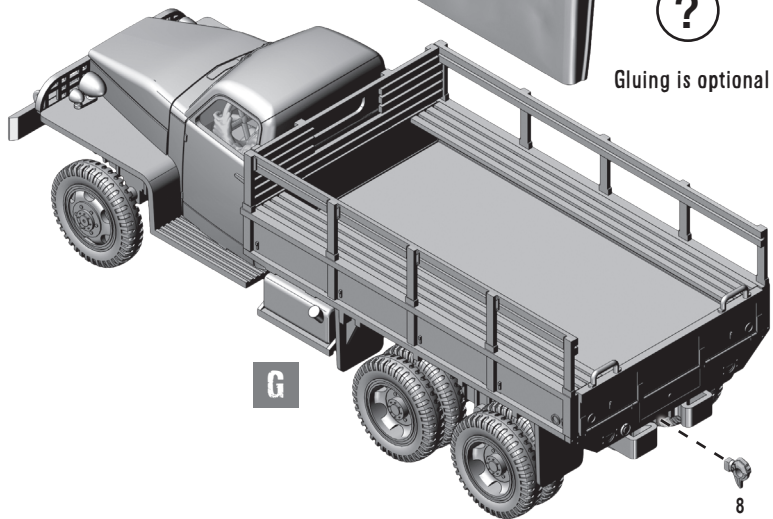
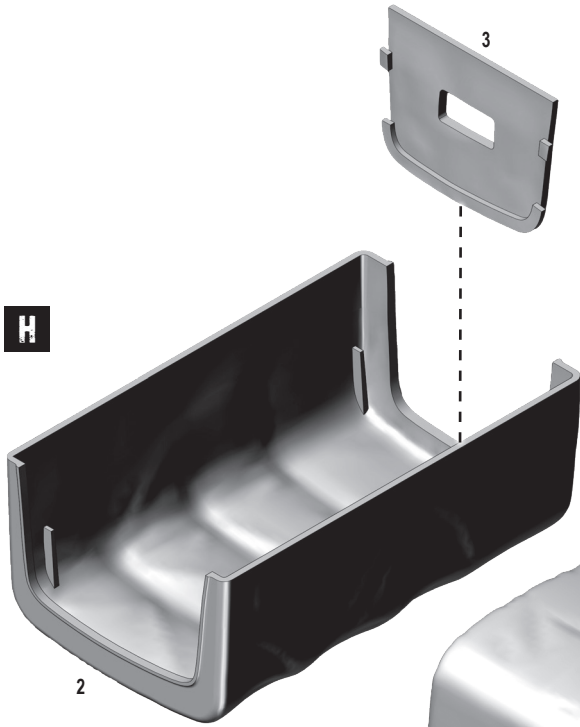

STUDEBAKER US6 TRUCK

Warpaints Fanatic Leafy Green

Warpaints Fanatic Skeleton Bone

Warpaints Fanatic Dusty Skull

Warpaints Fanatic Matt Black

Eastern Front, 1943



STUDEBAKER US6 TRUCK

Warpaints Fanatic Olive Drab

Warpaints Fanatic Skeleton Bone

Warpaints Fanatic Dusty Skull

Warpaints Fanatic Matt Black

North-West Europe , 1944



Component code: 407020018